

## **LIBERTYCAST<sup>PLUS</sup> 32 PORCELAIN ENAMEL 60" X 32" X 16 5/8" BATHTUB**



2642 130

RH Drain, Slip-Resistant

2643 130

LH Drain, Slip-Resistant

### **DESCRIPTION:**

The LibertyCast Plus 32 is a 60" x 32" x 16 5/8" deep soaker – 2" deeper than the standard 5' bathtub and 2" wider for spacious bathing with extra storage encased with premium insulation designed for maximum warmth, minimal noise and ultimate durability. LibertyCast Plus 32 is "the affordable alternative to cast iron" designed to improve heat retention and noise absorbing, while preventing handling and installation damage. The LibertyCast Plus 32 bathing area is full size with a 15" soaking depth. The LibertyCast Plus 32 has a 35 degree lumbar support for a more comfortable bathing experience. Construction is one piece heavy gauge seamless steel with an acid resistant porcelain enamel finish. The LibertyCast Plus 32 weighs 87 lbs., easy to install into bathtub alcove - "just set it and level it". The full length support pad offers added strength and sound deadening. This product is compatible or complies with ASME A112.19.1/CSA B45.2 (Standard for Enameled Steel Plumbing Fixtures), ADA (American Disabilities Act), ASTM F 462 (Safety Specification for Slip Resistant Bathing Facilities), WW-P 541 (U.S. Military Federal Specification), HUD-FHA-VA, LEED, and the Buy American Act, as applicable when installed accordingly. Available in white with a right and left drain. Made in the USA.

Weight: 87 lbs



812.423.5401 | [www.briggsbath.com](http://www.briggsbath.com)

# LIBERTYCAST PLUS 32 PORCELAIN ENAMEL 60" X 32" X 16 5/8" BATHTUB

## LibertyCast Plus 32 5' Bathtub

60" x 32" x 16 5/8"

Weight: 90 lbs

Standard Outlet

2642 130 RH Drain, slip-resistant

2643 130 LH Drain, slip-resistant

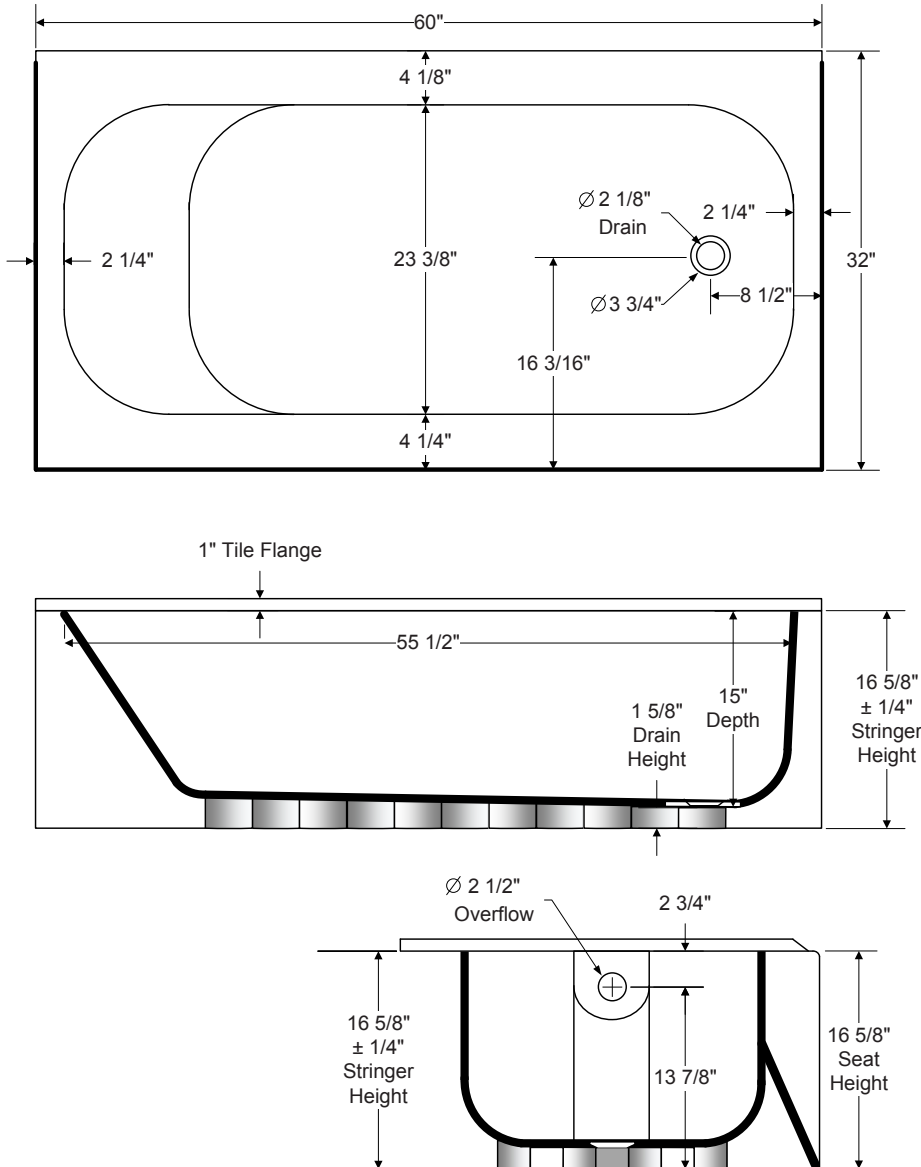

### Complies with:

All fixtures are compatible or comply with ANSI, ASME, CSA, WW-P 541, HUD-FHA-VA, LEED and the "Buy America Act" where applicable when installed accordingly.

### Standard Features:

"The affordable alternative to cast iron"  
Full length sound deadening pad  
Slip resistant bottom  
Set it and level it

Made in the USA

All Dimensions  $\pm 1/8"$  unless otherwise noted. Dimensions shown are for reference. Actual dimensions may vary slightly and should be checked prior to installation



812.423.5401 | www.briggsbath.com