



WAGNER 19" X 16" X 6 1/2"
PORCELAIN ENAMEL
OVAL UNDERMOUNT LAVATORY



3005 130 UNDER-MOUNT

DESCRIPTION:

Wagner 19" x 16" oval under-mount porcelain enamel lavatory is a contemporary design with a spacious bowl and concealed front overflow that mounts under the countertop – the under-counter lavatory works best when professionally installed with the latest natural or solid counter-top materials. The under-mount design can be used with wall mount or deck mount 4" or 8" faucet mounts – mounting clips or industrial adhesive is required for installation (not included) - weighs 10 lbs with acid resistant porcelain enameled steel - plastic overflow eliminates pop-offs and rust. The lavatory complies with ASME A119.1-2008/CSA B45.2-08 Enameled Cast Iron and Enameled Steel Plumbing Fixtures. **Available in white only.** Construction is one-piece heavy gauge seamless steel with an acid resistant porcelain enamel finish. Faucets not included. Made in the USA.

Weight: 10 lbs



WAGNER 19" X 16" X 6 1/2" PORCELAIN ENAMEL OVAL UNDERMOUNT LAVATORY

Wagner Oval Lavatory 19" x 16"

3005-130 Under-mount

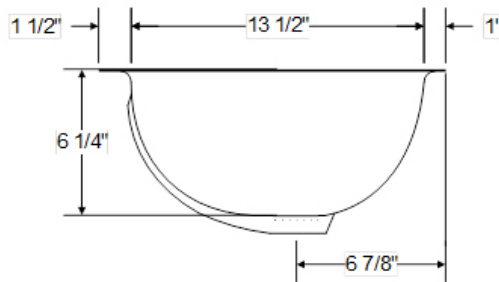
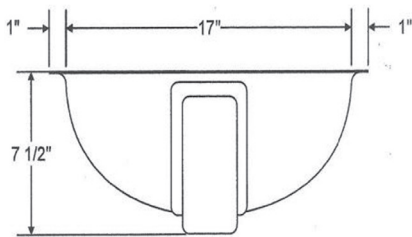
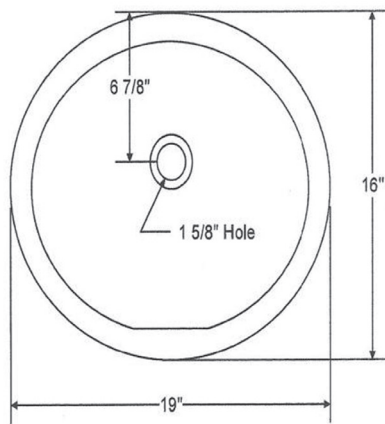

BRIGGS



Complies with:

All fixtures are compatible or comply with ANSI, ASME, CSA, WW-P 541, HUD-FHA-VA, LEED and the "Buy America Act" where applicable when installed accordingly.

Standard Features:

"The affordable alternative to cast iron"
Full length sound deadening pad
Slip resistant bottom
Set it and level it

Made in the USA

All Dimensions +/- 1/8" unless otherwise noted.
Dimensions shown are for reference.
Actual dimensions may vary slightly and
should be checked prior to installation